

PQS

PRACTICAL QUALITY SYSTEMS

Fast Custom Manufacturing - Nationwide Installation Services

UVHM-EX-1824-P3-VESA

PN 80007

A three position mounting plate with two extendable arms and two VESA tilt heads

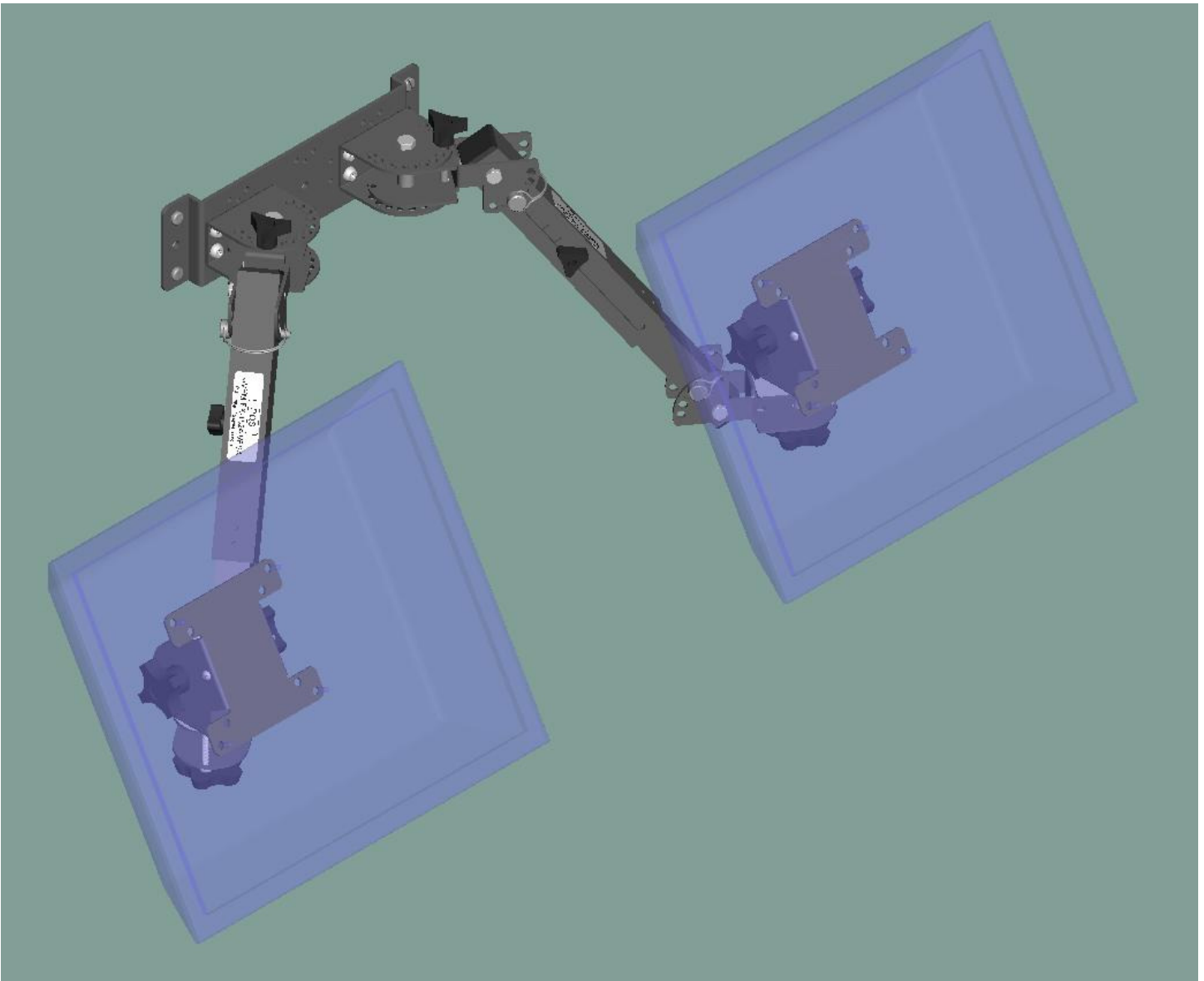

A three position mounting plate with two extendable arms and two VESA tilt heads

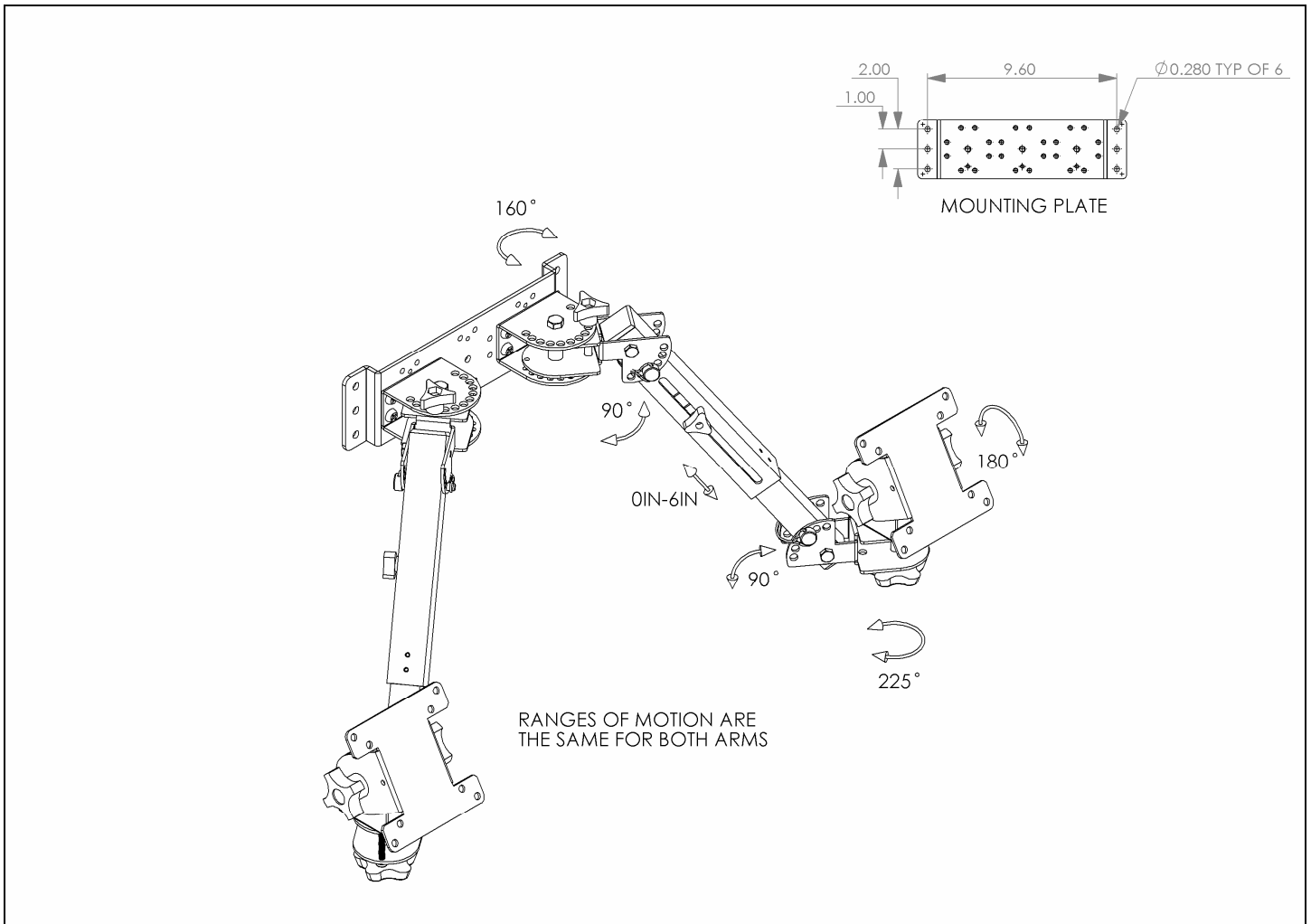

A three position mounting plate with two extendable arms and two VESA tilt heads**PRODUCT SPECIFICATIONS**

- Supports a Micros WS5 terminal or any 75 or 100 mm VESA compatible touch screen, terminal or flat panel monitor.
- The assembly supports touch screens, terminals or flat panel monitors up to 20" (all images are shown with a 17" screen).
- Attaches to a wall or any other flat vertical surface, or to a shelf or any other flat horizontal surface.
- VESA tilt heads adjust without tools to lock the screens at any position, side to side, or up and down.
- The arms can be extended to increase the mount's reach from 18" to 24."
- The outward and downward angle of the arms are adjustable at the top and bottom ends of the arms with special "offset" brackets and easy to use wire lock pins to set a wide range of selectable angles.
- The horizontal position of the arms can be easily changed and locked as needed by removing and reinserting a simple hand knob.
- The positions of the tilt heads can also be locked more securely for the long term by tightening the tilt head locking screws with a Phillips screw driver.
- This mount can also be reconfigured in the field to reach upward and outward from the mounting surface.
- This assembly is part of the UVHM system which includes many components that can be mixed and matched to create a support solution for any mounting location.
- Each arm supports up to 15 lbs.