

# PQS

PRACTICAL QUALITY SYSTEMS  
Fast Custom Manufacturing - Nationwide Installation Services

## Wall mounting system w/2 extendable arms and two screen pan and tilt heads PN 80007

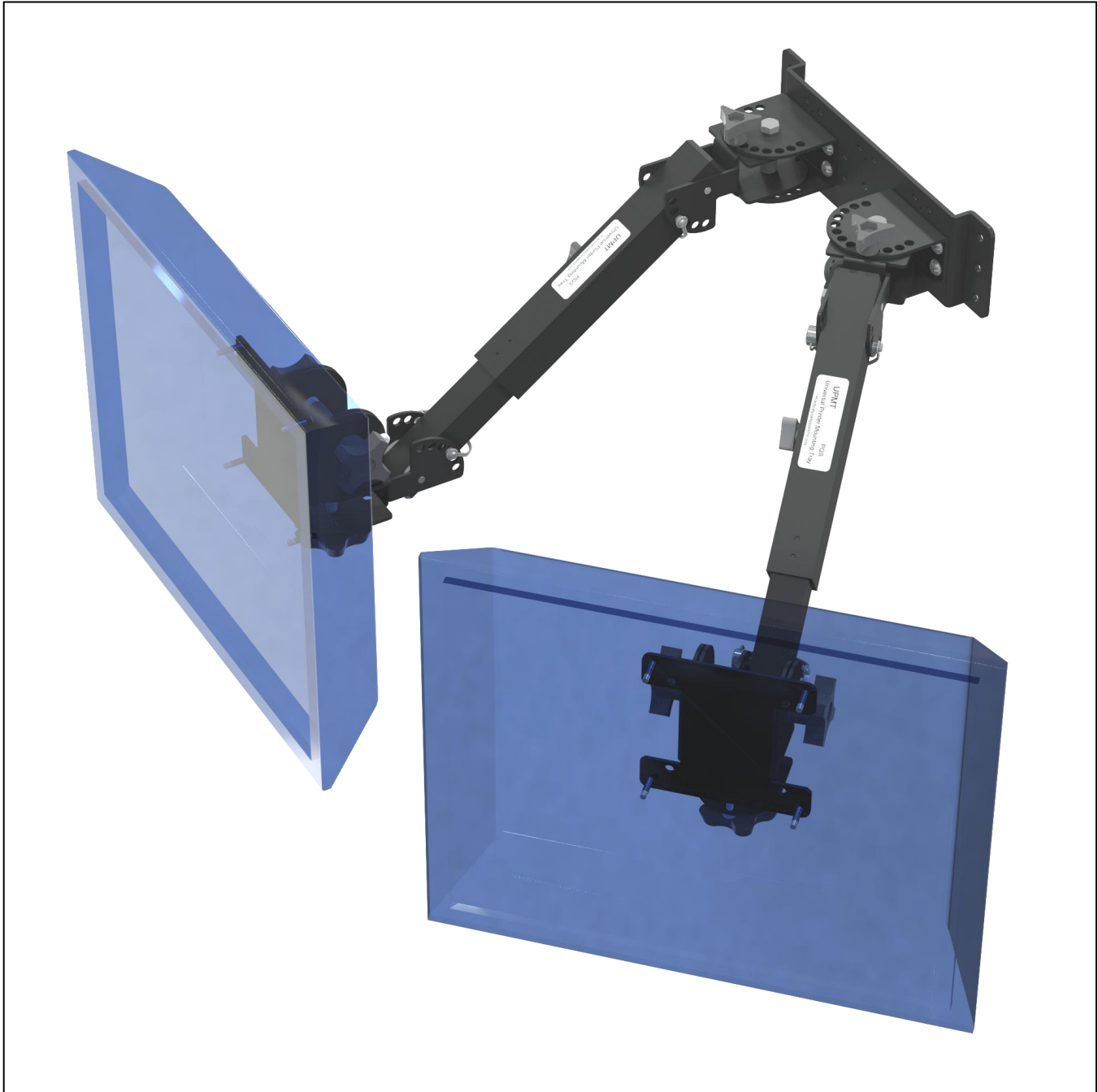

NOTE: 80007 with two 75/100mm VESA Pan and Tilt heads shown. All mounting systems are also available for NON VESA compatible screens.

[info@practicalqualitysystems.com](mailto:info@practicalqualitysystems.com) [WWW.PRACTICALQUALITYSYSTEMS.COM](http://WWW.PRACTICALQUALITYSYSTEMS.COM)

(818) 993-1022

**ALL PRODUCTS PATENT PENDING**

### Wall mounting system w/2 extendable arms and two screen pan and tilt heads PN 80007

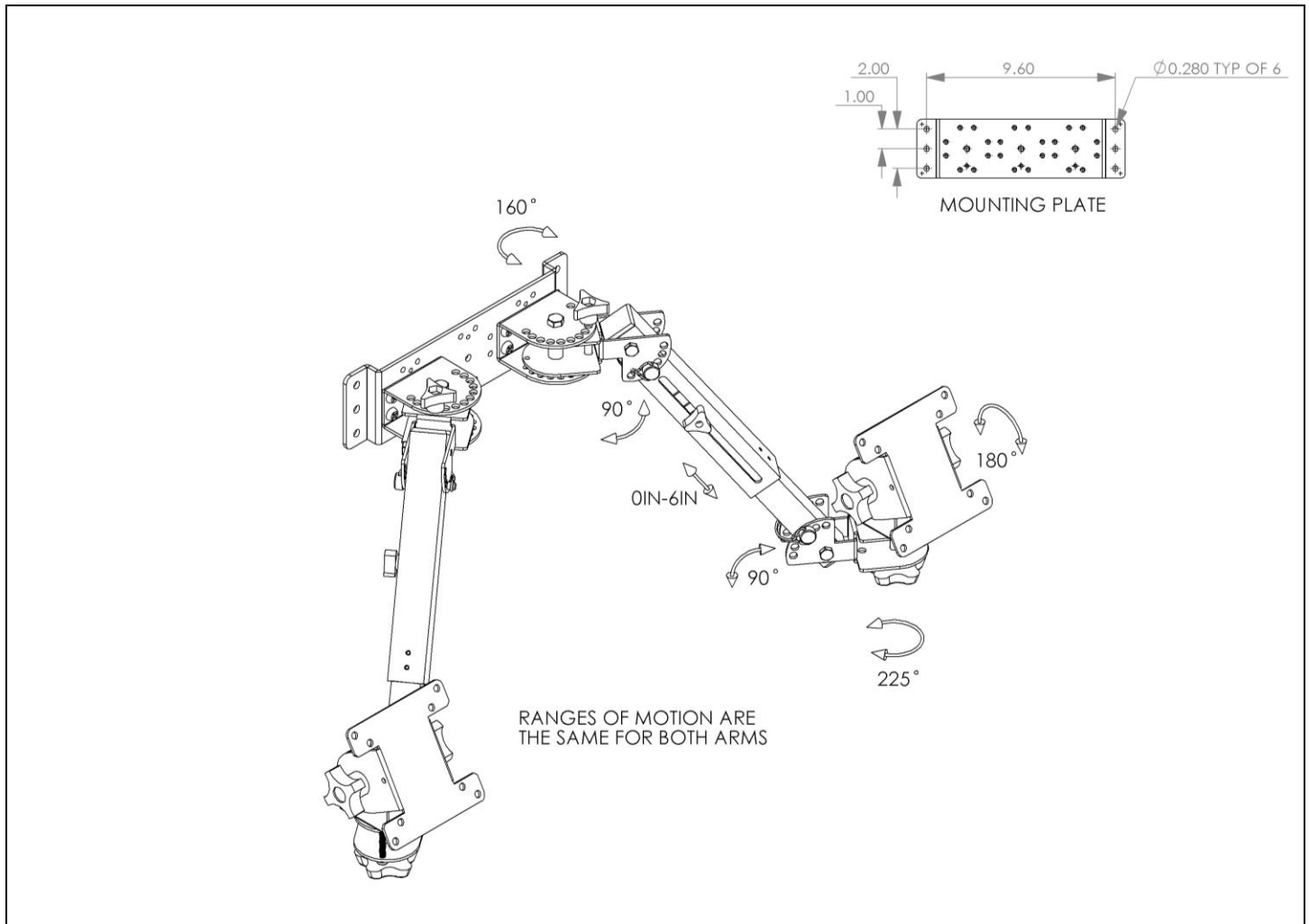

NOTE: 80007 with two 75/100mm VESA pan and tilt heads shown. All assemblies with NON VESA compatible pan and tilt heads will appear differently.

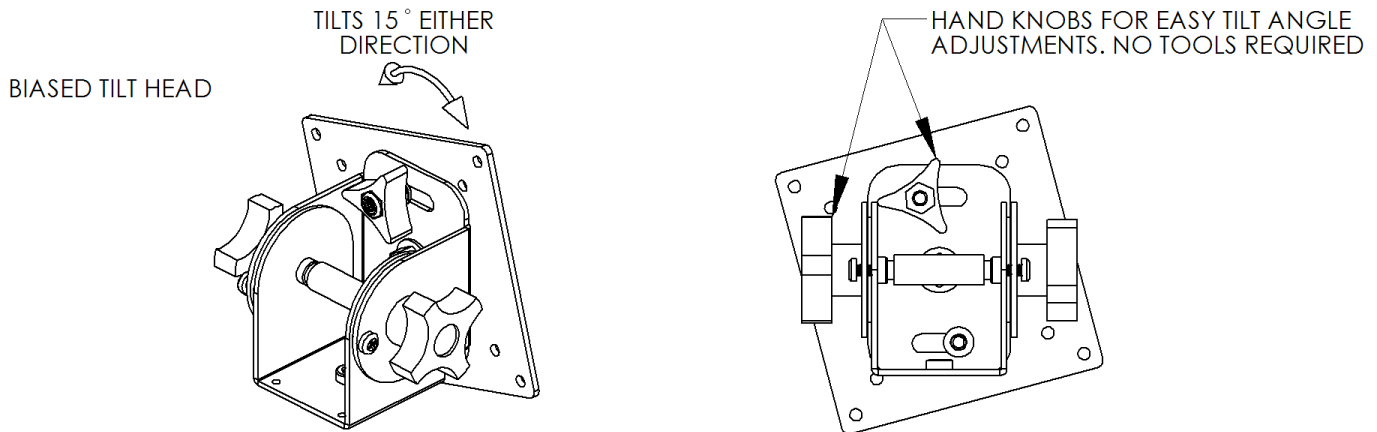

**Wall mounting system w/2 extendable arms and two screen pan and tilt heads PN 80007**

## PRODUCT SPECIFICATIONS

- The assembly supports touch screens, terminals or flat panel monitors up to 20" (all images are shown with a 17" screen).
- Attaches to a wall or any other flat vertical surface, or to a shelf or any other flat horizontal surface.
- Pan and tilt head has biased adjustment.
- Pan and tilt heads adjust without tools to lock the screens at any position, side to side, or up and down.
- The arms can be extended to increase the mount's reach from 18" to 24."
- The outward and downward angle of the arms are adjustable at the top and bottom ends of the arms with special "offset" brackets and easy to use wire lock pins to set a wide range of selectable angles.
- The horizontal position of the arms can be easily changed and locked as needed by removing and reinserting a simple hand knob.
- The position of the pan and tilt head can also be locked more securely for the long term by tightening locking screws on the pan and tilt head with a Phillips screw driver.
- This mount can also be reconfigured in the field to reach upward and outward from the mounting surface.
- Most of our modular mounting systems can be easily reconfigured in the field for a different application by either adding or removing a few parts to create a support solution for any mounting location.
- Each arm supports up to 15 lbs.
- All wall mountable assemblies can be ordered with an optional *Stud Bridge Mounting Plate* (PN 50360) that supports up to three arms and attaches to wall studs spaced at 16" on center.
- All wall mountable assemblies can be ordered with an optional *Pole Mounting Plate* (PN 50386) that supports up to three arms and attaches to any pole up to 8" diameter or column up to 24".
- For assembly instructions see the *User Manual* which can be downloaded from the *Product Resources* page on our website.
- To order this assembly use part number 80007.
- Available with pan and tilt heads to support all VESA and NON VESA compatible touch screens, terminals or flat panel monitors. Refer to the *Custom Fit Pan and Tilt Heads* page on our website found in the *Other Products* section for the most current list of options. If we don't have a compatible pan and tilt head; send us a sample of your screen and we'll create a *Custom Fit* solution for you.

Wall mounting system w/2 extendable arms and two screen pan and tilt heads PN 80007

MOUNTING OPTIONS:

- All of our screen pan and tilt heads can be used with any of the following mounting systems.

